



## Potters Rest\*\* Malvern House, Wogan Terrace, Saundersfoot, Pembrokeshire, SA69

A top floor flat located in the popular village of Saundersfoot. The accommodation includes an entrance porch, cloakroom, and an open-plan living room, kitchen, and dining area fitted with a range of modern units. The living space offers views over the village and towards the sea, with additional outlooks over the rear garden. There are two double bedrooms, both with views towards Saundersfoot Beach. One bedroom includes an en-suite shower room, and there is also a separate family bathroom. The property features a neutral décor throughout and benefits from gas central heating. Externally, the rear garden is mainly laid to lawn, leading to a raised decking area that overlooks Saundersfoot Village and offers sea views.

On successful application, a holding deposit of £195.40, equivalent to 1 week's rent (monthly rent / 4.35), will be required.

- Top Floor Flat
- Master with En-suite
- Well Presented
- Garden to Rear
- EPC Rating Band C
- Two Double Bedrooms
- Open Plan Living/Kitchen/Dining
- Sea Views
- Walking Distance to Beach
- Furnished

**RENT: £850 PCM**

**DEPOSIT: £950**



**40 High Street, Haverfordwest, Pembrokeshire, SA61 2DA** [info@westwaleshomerentals.co.uk](mailto:info@westwaleshomerentals.co.uk)



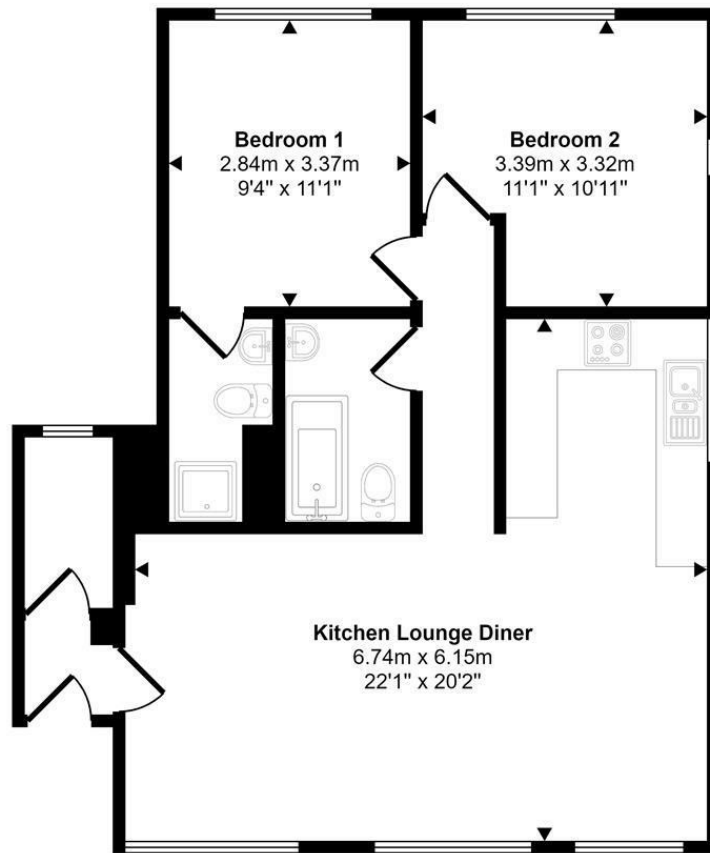

Floorplan

This floorplan is only for illustrative purposes and is not to scale. Measurements of rooms, doors, windows, and any items are approximate and no responsibility is taken for any error, omission or mis-statement. Icons of items such as bathroom suites are representations only and may not look like the real items. Made with Made Snappy 360.

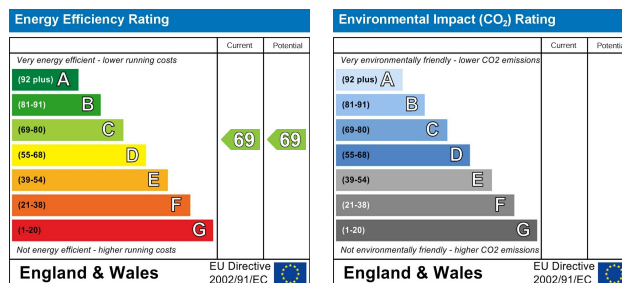

The particulars are set out as a general outline only for the guidance of intended purchasers or lessees, and do not constitute, any part of a contract. Nothing in these particulars shall be deemed to be a statement that the property is in good structural condition or otherwise nor that any of the services, appliances, equipment or facilities are in good working order. Purchasers should satisfy themselves of this prior to purchasing.

**COMPUTER-LINKED OFFICES THROUGHOUT WEST WALES and Associated Office in Mayfair, London**